

## Dixon Bevel Seat Fittings

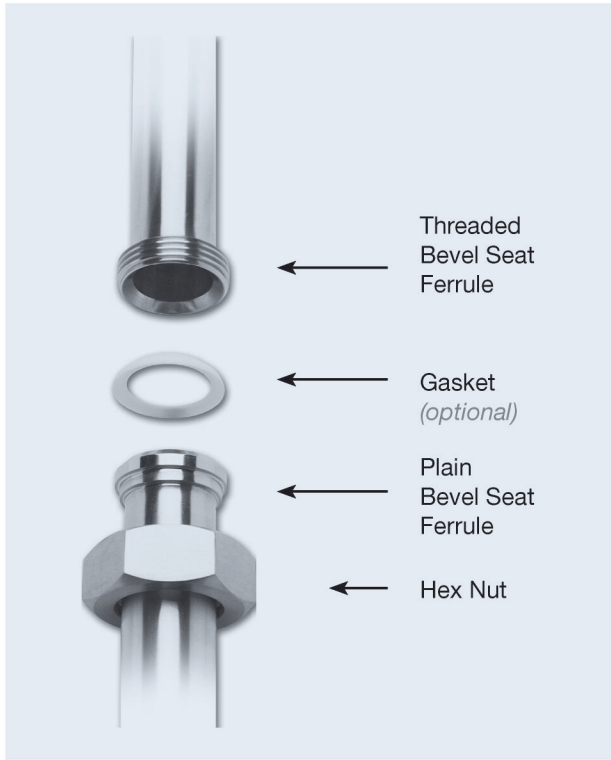

### A Complete Bevel Seat Connection



### Product Specifications

- Size range:** • 1" - 4" OD tube
- Materials:**
- G = 304 stainless steel
  - R = 316L stainless steel
  - other alloys are available
- Finish:** • 3A sanitary finish ID and OD

**B**

### Dimensions of stainless steel tube given in inches

Tube OD	Nominal Wall Thickness (inches)	Gage Number
1"	.065	16
1½"	.065	16
2"	.065	16
2½"	.065	16
3"	.065	16
4"	.083	14

## Bevel Seat Nuts

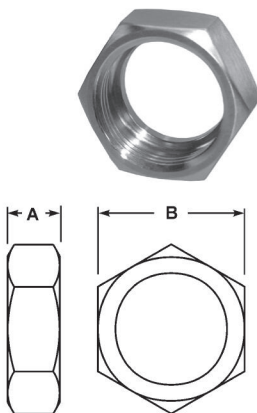

### UNION HEX NUTS - 13H

304 STAINLESS STEEL (CF8) PART NO.	TUBE O.D.	DIMENSION	
		A	B
13H-G100	1"	.906	1.812
13H-G150	1½"	.968	2.406
13H-G200	2"	1.062	3.000
13H-G250	2½"	1.187	3.594
13H-G300	3"	1.281	4.188
13H-G400	4"	1.500	5.438

**Feature:**

- 400 PSI maximum

## Bevel Seat Wrenches

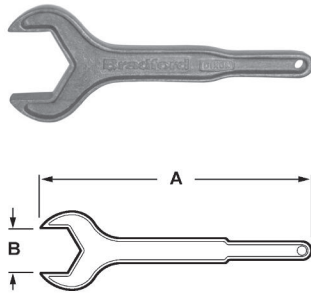

### SINGLE SIDE HEX WRENCHES - 25H

ALUMINUM PART NO.	TUBE O.D.	DIMENSION		WEIGHT LBS.
		A	B	
13H-G100	1"	10.500	1.812	.64
13H-G150	1½"	12.000	2.406	.86
13H-G200	2"	14.000	3.000	1.76
13H-G250	2½"	16.250	3.594	2.40
13H-G300	3"	18.500	4.188	3.04
13H-G400	4"	19.500	5.438	3.62

**B**

## Bevel Seat Ferrules

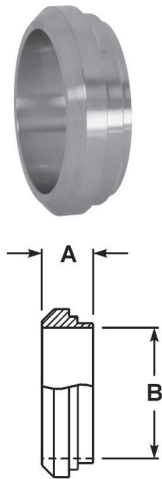

### SHORT PLAIN BEVEL SEAT WELD FERRULES - 14PRF

304 STAINLESS STEEL PART NO.	316L STAINLESS STEEL PART NO.	TUBE O.D.	DIMENSION	
			A	B
14PRF-G100	14PRF-R100	1"	.718	.870
14PRF-G150	14PRF-R150	1½"	.718	1.370
14PRF-G200	14PRF-R200	2"	.750	1.870
14PRF-G250	14PRF-R250	2½"	.875	2.370
14PRF-G300	14PRF-R300	3"	.906	2.870
14PRF-G400	14PRF-R400	4"	1.031	3.834

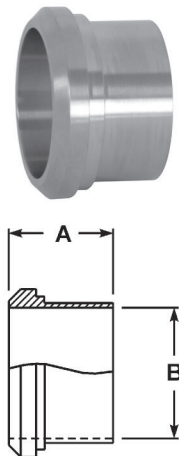

### LONG PLAIN BEVEL SEAT WELD FERRULES - 14A

304 STAINLESS STEEL PART NO.	316L STAINLESS STEEL PART NO.	TUBE O.D.	DIMENSION	
			A	B
14A-G100	14A-R100	1"	1.375	.870
14A-G150	14A-R150	1½"	1.500	1.370
14A-G200	14A-R200	2"	1.500	1.870
14A-G250	14A-R250	2½"	1.750	2.370
14A-G300	14A-R300	3"	1.750	2.870
14A-G400	14A-R400	4"	1.750	3.834

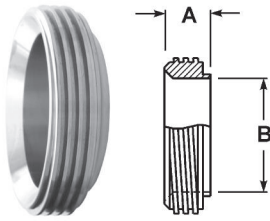

## SHORT THREADED BEVEL SEAT WELD FERRULES - 15TRF

304 STAINLESS STEEL PART NO.	316L STAINLESS STEEL PART NO.	TUBE O.D.	DIMENSION	
			A	B
15TRF-G100	15TRF-R100	1"	.718	.870
15TRF-G150	15TRF-R150	1½"	.718	1.370
15TRF-G200	15TRF-R200	2"	.750	1.870
15TRF-G250	15TRF-R250	2½"	.875	2.370
15TRF-G300	15TRF-R300	3"	.906	2.870
15TRF-G400	15TRF-R400	4"	1.031	3.834

**B**

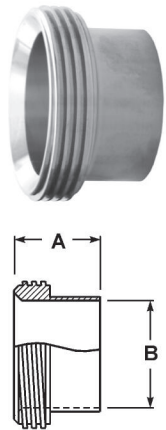

## LONG THREADED BEVEL SEAT WELD FERRULES - 15A

304 STAINLESS STEEL PART NO.	316L STAINLESS STEEL PART NO.	TUBE O.D.	DIMENSION	
			A	B
15A-G100	15A-R100	1"	1.375	.870
15A-G150	15A-R150	1½"	1.500	1.370
15A-G200	15A-R200	2"	1.500	1.870
15A-G250	15A-R250	2½"	1.750	2.370
15A-G300	15A-R300	3"	1.750	2.870
15A-G400	15A-R400	4"	1.750	3.834

## Bevel Seat End Caps

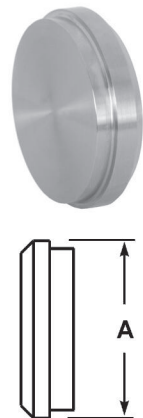

## PLAIN BEVEL SEAT SOLID END CAPS - 16A

304 STAINLESS STEEL PART NO.	316L STAINLESS STEEL PART NO.	TUBE O.D.	DIMENSION
			A
16A-G100	16A-R100	1"	1.312
16A-G150	16A-R150	1½"	1.843
16A-G200	16A-R200	2"	2.375
16A-G250	16A-R250	2½"	2.906
16A-G300	16A-R300	3"	3.437
16A-G400	16A-R400	4"	4.500

Other types of bevel seat adapters are available call Dixon for information



15AHR

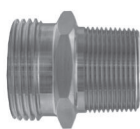

21



22

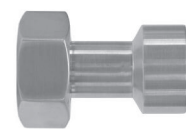

14-18

## Bevel Seat Gaskets

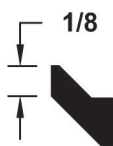

**B**

### Features:

- color code: red dot
- meets 21CFR 177.2600

### BUNA-N BEVEL SEAT GASKETS - BLACK

PART NO.	SIZE
40BS-O100	1"
40BS-O150	1½"
40BS-O200	2"
40BS-O250	2½"
40BS-O300	3"
40BS-O400	4"

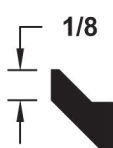

### Features:

- color code: three green dots
- peroxide cured
- meets 21CFR 177.2600
- passed U.S.P. Class VI Cytotoxicity testing

### EPDM BEVEL SEAT GASKETS - BLACK

PART NO.	SIZE
40BS-O100	1"
40BS-O150	1½"
40BS-O200	2"
40BS-O250	2½"
40BS-O300	3"
40BS-O400	4"

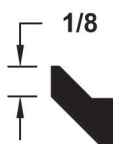

### Features:

- color code: one white dot and one yellow dot
- peroxide cured
- meets 21CFR 177.2600
- passed U.S.P. Class VI Cytotoxicity testing

### FKM BEVEL SEAT GASKETS - BLACK

PART NO.	SIZE
40BS-Y100	1"
40BS-Y150	1½"
40BS-Y200	2"
40BS-Y250	2½"
40BS-Y300	3"
40BS-Y400	4"

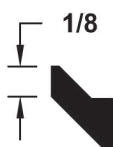

### Features:

- color code: no dot
- peroxide cured
- meets 21CFR 177.2600
- passed U.S.P. Class VI Cytotoxicity testing

### SILICONE BEVEL SEAT GASKETS - WHITE

PART NO.	SIZE
40BS-X100	1"
40BS-X150	1½"
40BS-X200	2"
40BS-X250	2½"
40BS-X300	3"
40BS-X400	4"

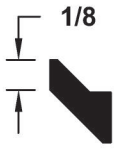

**Features:**

- color code: no dot
- meets 21CFR 177.1550
- passed U.S.P. Class VI Cytotoxicity testing

## PTFE BEVEL SEAT GASKETS - WHITE

PART NO.	SIZE
40BS-S100	1"
40BS-S150	1½"
40BS-S200	2"
40BS-S250	2½"
40BS-S300	3"
40BS-S400	4"

**B**

### CAUTION

PTFE is a material subject to plastic flow. When cycled through heat and then cooled down in process lines, PTFE gaskets will not return to the original configuration and it will continue to compress as the cycling continues. This plastic flow will allow leakage if clamp torques are not maintained.